

with **CHAMBER**



Art. 43065 **65lt**



Art. 43091 **90lt**

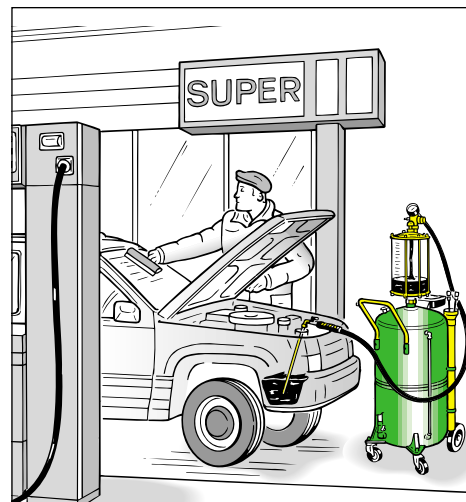

The **air-operated drainers** are ideal for quick engine oil change (by means of suction) of any motor vehicle.

The transparent chamber allows the **quantity and quality of sucked oil to be checked immediately**.

Once depressurized, they work autonomously anywhere because they do not require continuous connection to the compressed-air system.

The oil must be hot (70/80°C).

Art. 43065 **Air-operated oil drainer with transparent chamber**, wheel-mounted 65-litre tank equipped with level-gauge, supplied with set of probes (art. 45560) See page 122

N° 2 packing  $m^3$  0,230 kg 32,9

Art. 43091 **Air-operated oil drainer with transparent chamber**, wheel-mounted 90-litre tank equipped with level-gauge, supplied with set of probes (art. 45560) See page 122

N° 2 packing  $m^3$  0,250 kg 36

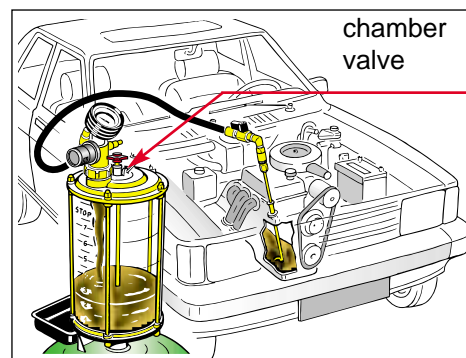

The **chamber valve** enables the drainer to be used with bowl vacuum only, thus preventing the tank vacuum from being discharged once the oil has been drained.

Article	43065	43095
Tank capacity	65 lt	90 lt
Max. draining capacity	52 lt	75 lt
Chamber capacity	8 lt	8 lt
Air pressure for vacuum	7 bar	7 bar
Depressurization time	2 min	2,5-3 min
Noise level	75 dB	75 dB
Suction speed with oil at 70-80°C, probes 6 mm.	1,5-2 lt/min	1,5-2 lt/min
Total suction capacity	43-45 lt	60-65 lt
Suction hose	2 m	2 m
Draining hose	2 m	2 m
Max. discharge pressure	0,5 bar	0,5 bar

**Important:** DO NOT drain brake fluids, fuels or flammable liquids of any kind, corrosive liquids.

### Overall dimensions

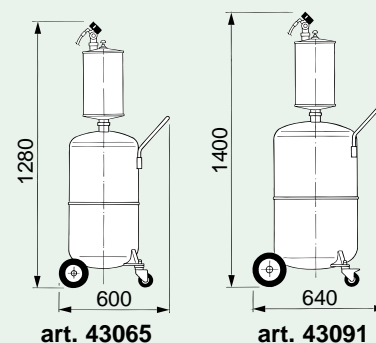

For the right depressurization, the air pressure **must necessarily be between 6.5 and 7 bar.**

Vacuum gauge for checking suction power  
Chamber-tank connection and oil drain plug

Transparent chamber with level-gauge

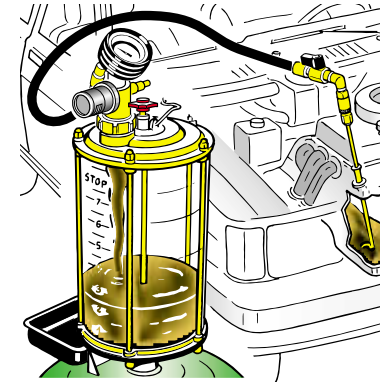

Suction hose length 2 metres with probe connection

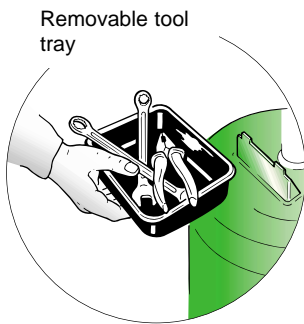

Removable tool tray

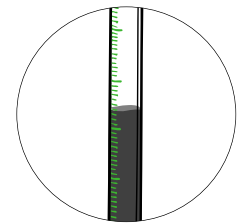

Level-gauge with scale in litres and gallons

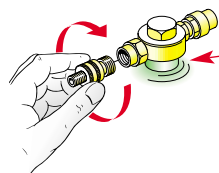

Unit with safety valve 1 bar and universal cock 1/4"G

Removable probe container

Tank emptying cock

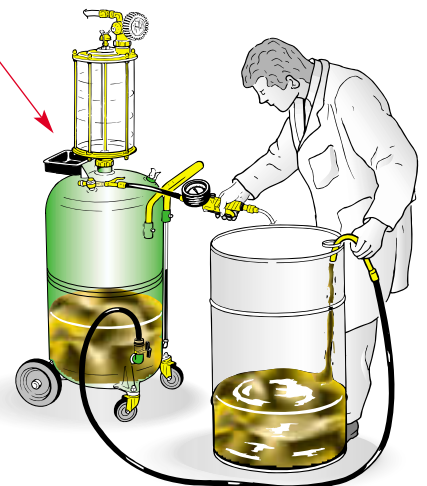

2 m hose for draining of tank with air.



Steady and practical wheel-mounted base